



\* Artist Impression only

**LIMITED  
24 UNITS**  
Lifestyle  
Retail Lots



**Jiran**  
MORI • RAWANG

**SCIENTEX**<sup>®</sup>  
healthy, friendly & happy ...

# Be in the centre of a bustling commercial hub

Experience the vibrant energy of Jiran@Mori Residences 2. This bustling hub in Rawang is the burgeoning neighborhood in the area, making it the most sought-after address in Northern Kuala Lumpur/Klang Valley. Join this thriving community, where your business can grow and immerse itself in the lively atmosphere.



## 10,000

Estimated residents  
within 1km of JIRAN



## 129k

 Estimated population

in surrounding townships



Affluent township

**Taman Scientex, Kota Emerald,  
Tamansari, Templer Residence,  
Taman Anggun 1, 2 & 3**



Amenities

**Aeon Mall, Lotus's Hypermarket,  
McDonald's, Proton 5S Center,  
Honda 4S Center, Anggun City,  
Straits International School**



Coming soon

**Knewton International School,  
Selgate Hospital, Uniqlo, Starbucks**



\* Artist Impression only

# Floorplan

## GROUND FLOOR



## FIRST FLOOR

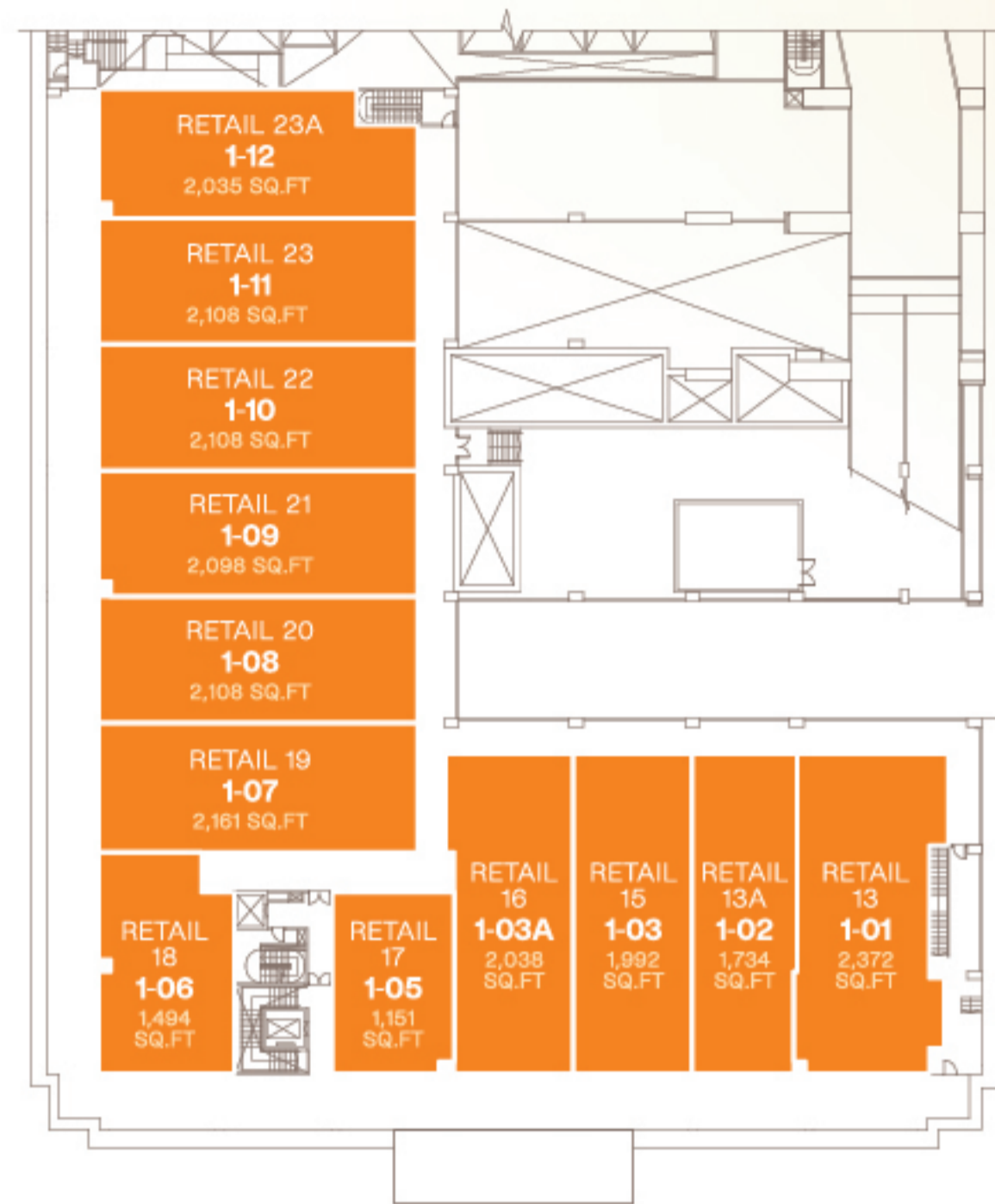

## Dynamic • Flexible • High-Potential

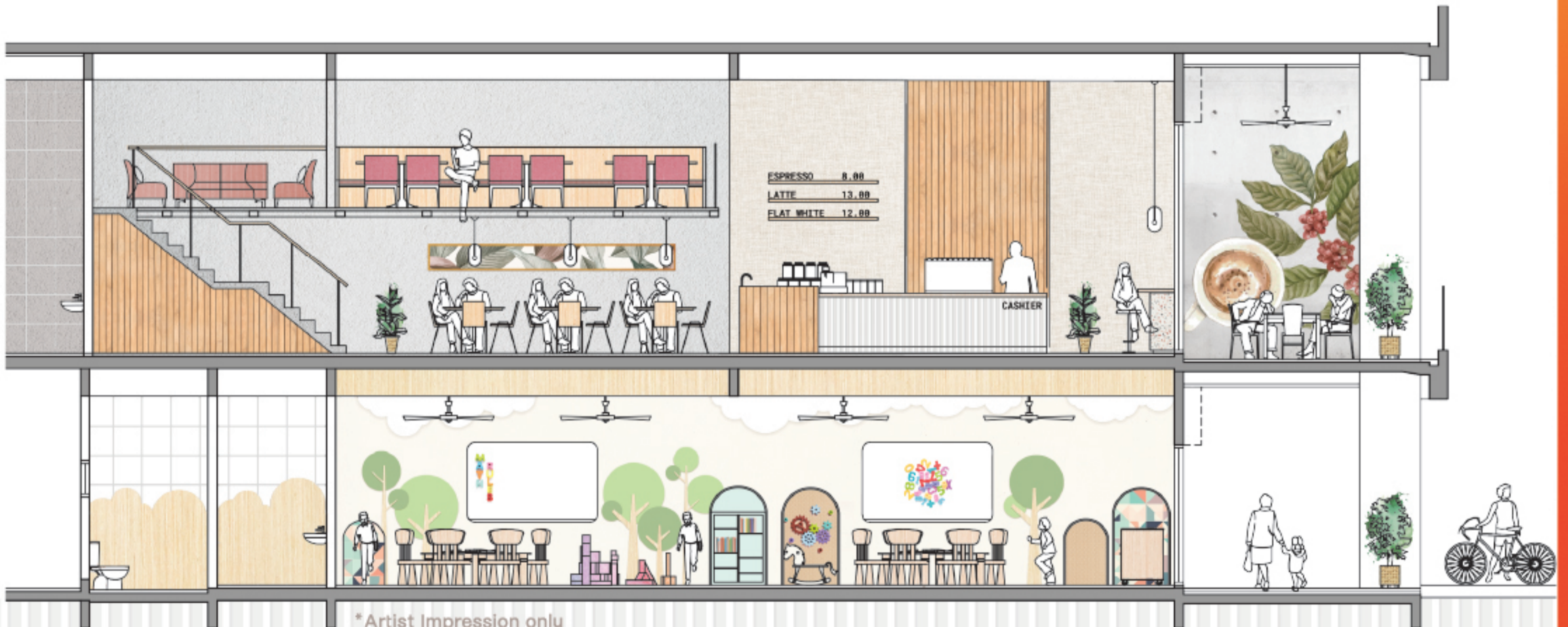

Prime Location with Main Road Frontage and High Visibility.



Spacious Units Designed for Alfresco Settings with Wide Walkways.



Extended Ceiling Height on First Floor Units for Mezzanine Creation.

# Venture into your next business move

Uncover limitless opportunities and embark on a new business journey with Jiran@Mori Residences 2. This exceptional commercial hub provides everything you need to flourish. With a substantial customer base, exciting activities, and convenient highway access, Jiran@Mori Residences 2 is the ultimate choice for your business in Rawang.

**Convenience** | **Easy Access**  
by visitors & residents

## Connecting Major Highways

North-South Expressway  
Guthrie Corridor Expressway  
LATAR Expressway  
Jalan Rawang – Bestari Jaya

## Accessibility

**5-min** to Rawang Toll Plaza  
**25-min** to Kuala Lumpur  
**17-min** to Sg. Buloh Toll Exit  
**30-min** to Damansara Toll Exit



[WWW.MORIRESIDENCES.COM.MY](http://WWW.MORIRESIDENCES.COM.MY)

DEVELOPER  
**SCIENTEX PARK (M) SDN. BHD.**  
(266710-D) (A Subsidiary of Scientex Berhad)  
No. 9, Persiaran Selangor, Seksyen 15,  
40200 Shah Alam, Selangor Darul Ehsan.

VISIT US  
**SCIENTEX RAWANG  
SALES GALLERY**  
Persiaran Anggun, Sungai Bakau,  
48000 Rawang, Selangor.

Mori Residences Sales Gallery  
 Mori Residences, Scientex Rawang  
 moriresidences

OPENING HOURS  
Monday to Friday 9AM – 6PM  
Saturday, Sunday 10AM – 6PM  
& Public Holidays  
E rawangproperty@scientex.com.my

All information contained here (including figures, specification, plan measurement and illustration) are subject to amendments, variations and modifications without notification as may be required by the relevant authorities or developer's consultants, and is not intended to form and cannot form part of an offer or contract. All images, pictures, plan and illustrations are artist's impressions only and may be subjected to changes. Whilst every reasonable care has been taken in preparing this information, the developer cannot be held liable for any variation or inaccuracy.

**SCIENTEX**  
healthy, friendly & happy