

UNMATCHED LOCATION.
UNMATCHED POTENTIAL.

5KM

- SK Pokok Sena
- SMK Pokok Sena
- SJK (C) Lee Chee
- Universiti Sains Malaysia (USM)
- Maktab Rendah Sains MARA (MRSM)
- Mydin Hypermarket
- Sunshine Bertam
- Maybank

10KM

- Lotus's Bertam Perdana
- KFC | Pizza Hut | Domino's
- CIMB Bank
- Bank Rakyat
- Bertam Resort & Waterpark
- Penang Golf Resort

20KM

- Hospital Seberang Perai
- Penang Sentral
- Kulim Hi-Tech Park
- Sunway Carnival Mall
- Aeon Alma
- SMJK Chung Ling
- Jit Sin High School



For more information, please call

☎ 04 573 5833 | 012 477 5583

penang@scientex.com.my
www.scientex.com.my

SCIENTEX[®]
SUNGAI DUA

AVENUE
@ SUNGAI DUA
2 STOREY SHOP OFFICE



Scientex Quatari Sdn. Bhd.
197601002045 (28008-M)
(Subsidiary of Scientex Berhad)

Lot 4358, Mukim 12, Jalan Gelugor,
13300 Tasek Gelugor, Pulau Pinang

The information contained is subject to change and cannot form part of an offer or contract. All renderings are artist's impression only. While every reasonable care has been taken in preparing this advertisement, the developer cannot be held responsible for any inaccuracy. All the above items are subject to variation, modifications & substitutions as may be required by Authorities or recommended by the Architect or Engineer. *Terms & Conditions Apply

SALES GALLERY OPEN DAILY
Monday - Friday: 9am - 6pm | Saturday, Sunday & Public Holiday: 10am - 6pm



SCIENTEX

Artist Impression Only

The Future THRIVES HERE

FUELED BY LOCATION, PEOPLE AND POSSIBILITY



Maximum Exposure

Prime exposure, strong traffic



154,000 Surrounding Population

Strong potential customer base



High-Growth Zone

Strong upward momentum



Strategic Location

10KM to North-South Highway

20KM to Penang Bridge



Extensive On-site Parking

Convenient for customers & tenants



*Artist Impression Only

FLOOR PLAN

Standard Land Size

20' x 70'

Standard Built-up Area

2,652 SQ. FT.

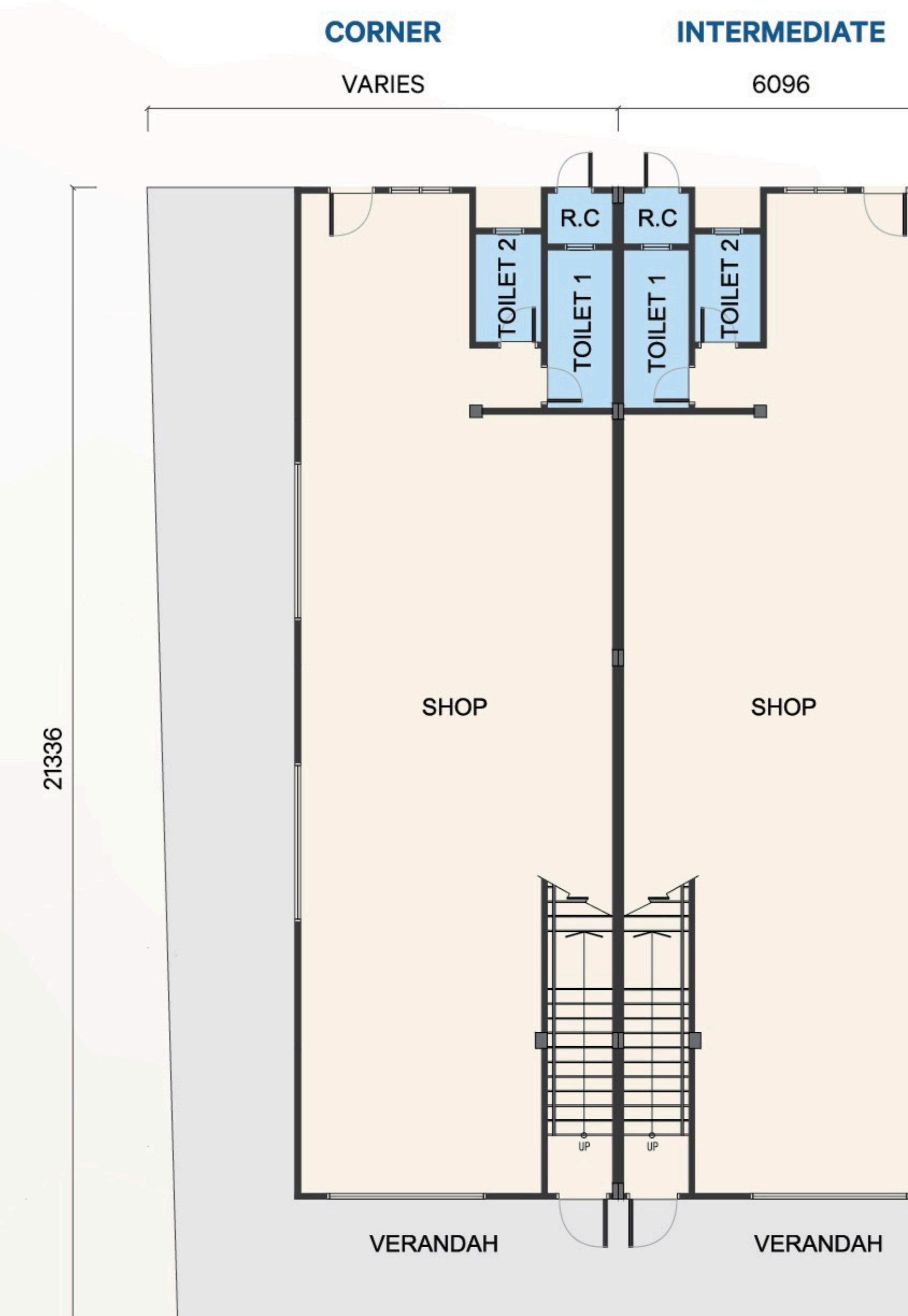

GROUND FLOOR

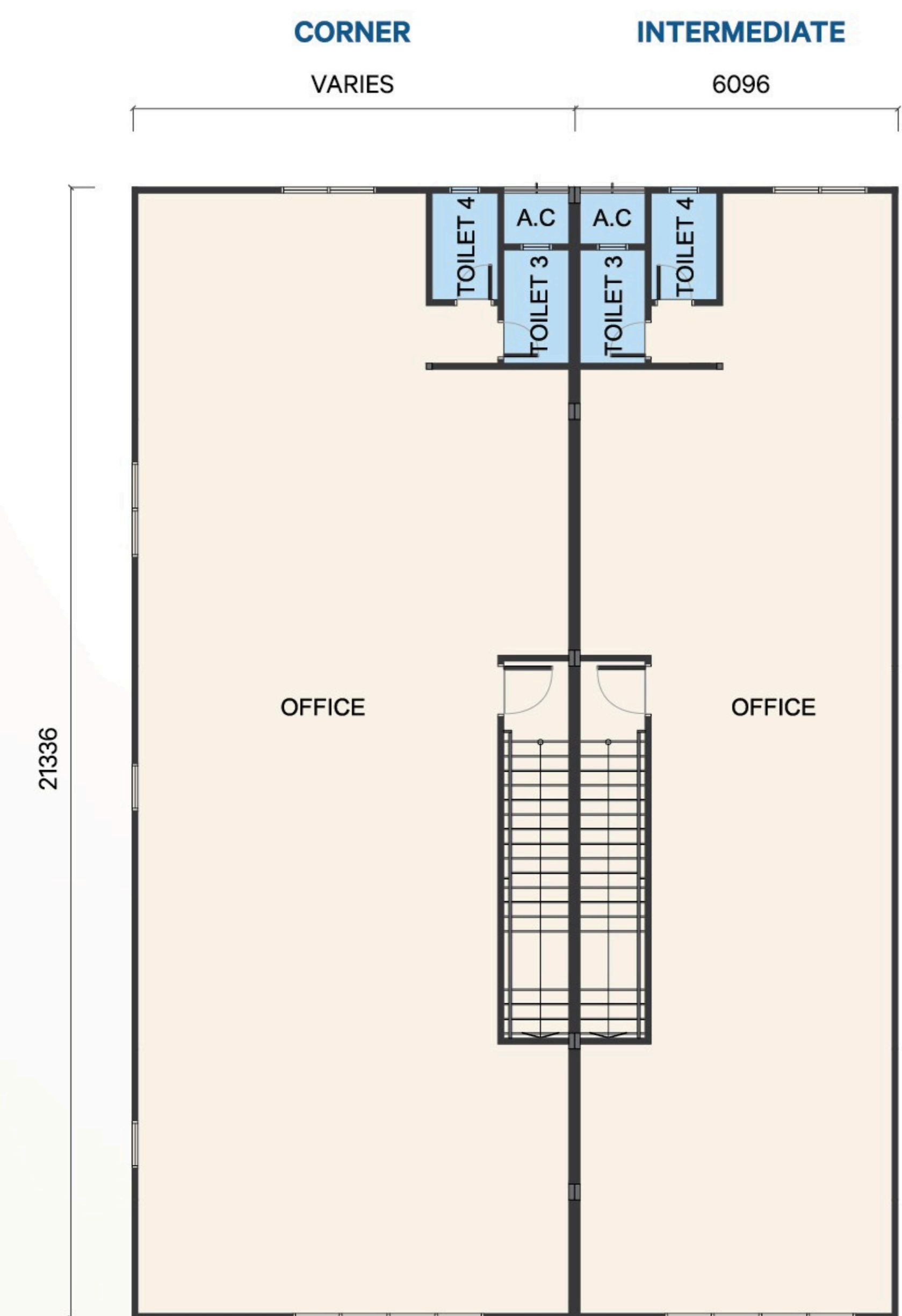

FIRST FLOOR

SPECIFICATION

Structure

Reinforced concrete frameworks

Wall

Brick wall

Roofing

Metal roofing sheets

Ceiling

Asbestos free ceiling board / Skim coat plaster

Windows

Aluminium framed windows

Door

Main entrance - Roller shutter
Rear entrance - M.S. door
Staircase entrance - Fire-rated door at upper floors
Others - Timber flush door / PVC door

Ironmongery

Approved quality lockset

Wall Finishes

Toilet - 1500mm high Ceramic Tiles
Others - Plaster and paint

Floor Finishes

Shop / Office - Cement Render
Toilet - Anti-slip Ceramic Tiles
Others - Cement Render

Sanitary & Plumbing Fittings

Approved quality sanitary wares & fittings

Electrical Installation

| Item | Type A, B & C | | |
|--------------------------|---------------|--------|-----|
| | Intermediate | Corner | End |
| Lighting Point | 20 | 23 | 20 |
| 13A Switch Socket Outlet | 10 | 10 | 10 |
| Ceiling Fan Point | 4 | 4 | 4 |
| Telephone Point (FWS) | 2 | 2 | 2 |